

ZBLEND TAPE LIGHT – 30/40K or 30/50K BLENDED



30/40K or 30/50K
90 CRI, Blended LED
alternating Chip Placement:
A technology for more
uniform and enhanced
color rendering.



APPLICATIONS
Ideal for linear and commercial
lighting applications—perfectly
suited for convenience stores,
grocery stores, bakeries, and
grab-and-go food displays,
delivering true color clarity and
a clean, modern presentation.

PRODUCT SPECIFICATIONS

| | |
|------------------------------|--|
| COLOR TEMPS ZBLEND | 30/40K (35K equivalent) 30/50K (40K equivalent) |
| DIMENSIONS | 5m / 100 ft Roll |
| LED TYPE | 2835 LED |
| LED QTY/FT | 36 LEDs/ft |
| VOLTAGE | DC24V |
| INPUT CURRENT (A) | .14A/ft |
| POWER | 3.4W/ft |
| POWER RANGE | 10~12W |
| MAX RUN | 32 ft. |
| RATED | IP65 |
| WARRANTY | 5 year |
| PART NUMBER | ZB-TAPE-24V-30/40K-HO-IP65 |
| | ZB-TAPE-24V-30/50K-HO-IP65 |



DIMENSIONS

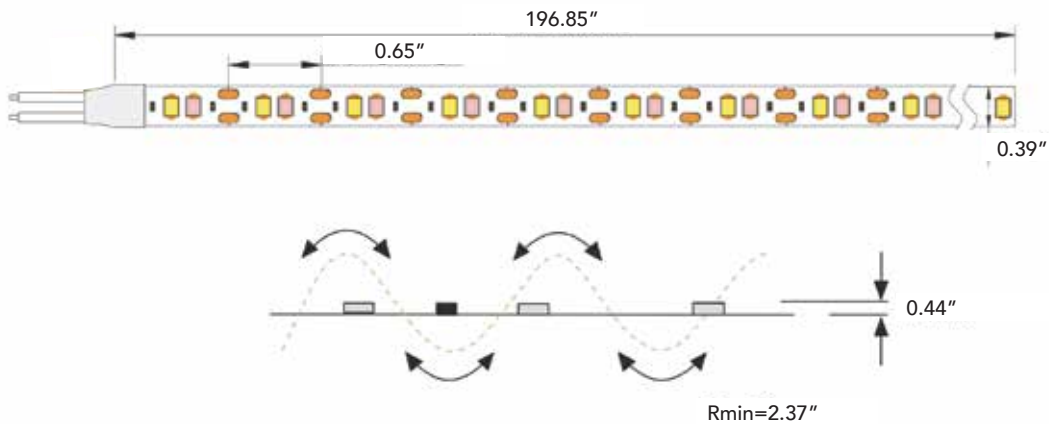

The Ultimate Evolution
in LED Lighting with
True Color Technology

ZBLEND TAPE LIGHT – 30/40K or 30/50K BLENDED

RENDERING INDEX COMPARISON



ZLBEND 30K/50K
90+ CRI LEDs



Standard 40K/80 CRI LEDs

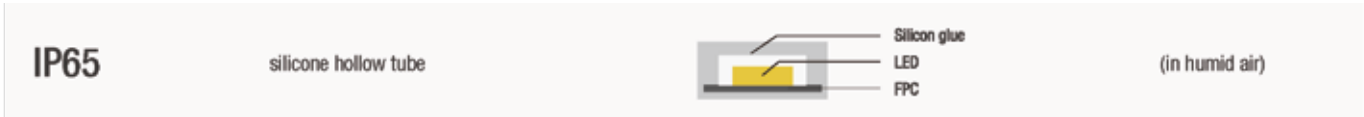

30/40K or 30/50K: 90+ CRI

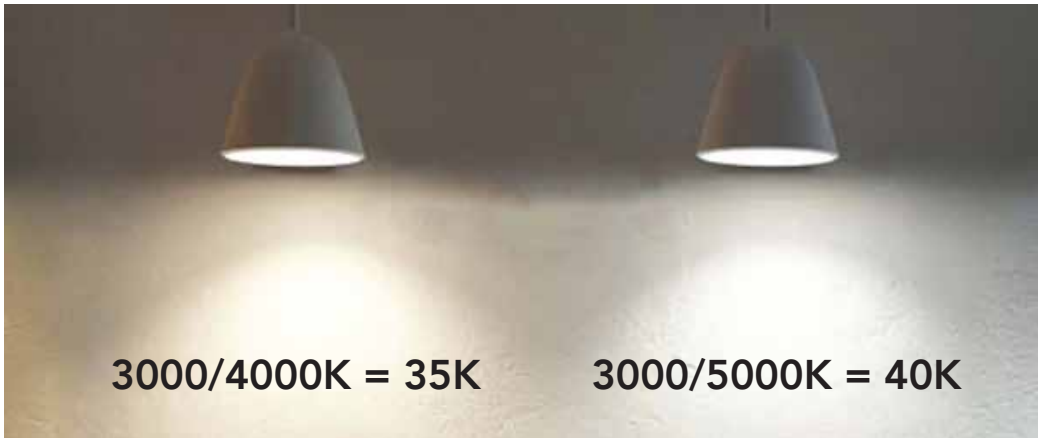

WIRING DIAGRAM

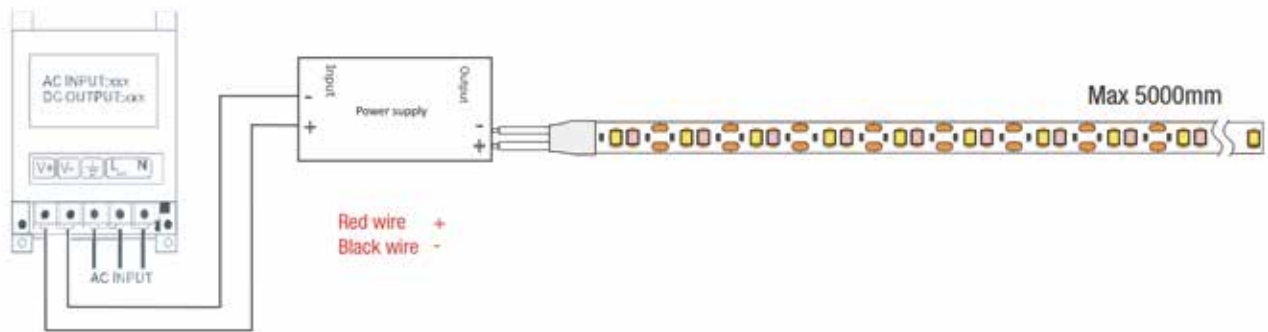

ZBLEND TAPE LIGHT – 30/40K or 30/50K BLENDED

INSTALLATION STEPS

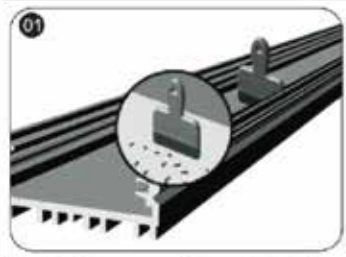

01 Ensure the Installation surface is clean.

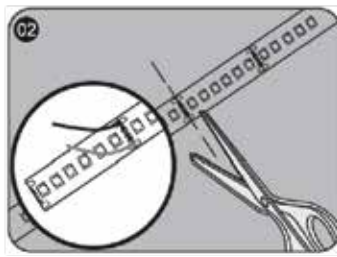

02 Cut LED Strip to length required. Use cutting lines as a guide.

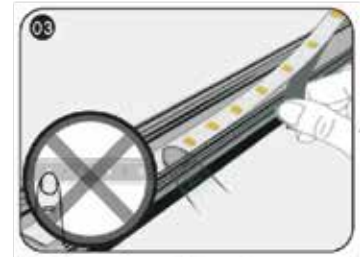

03 Remove backing from tape. Press tape to installation surface. Use care not to press on the LEDs.



04 Note that the cut marks are the locations of electrical contacts. Ensure these are isolated with the adhesive tape the avoid short circuits

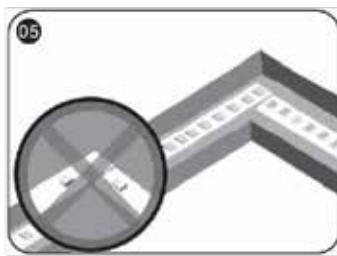

05 At corners, cut tape and start a new run. Do not bend tape into right angles



06 After Tape is installed, it can be connected to the power.

CAUTION:

When Installing the LED Strip, the LED strip can be bent, but see the restrictions noted below

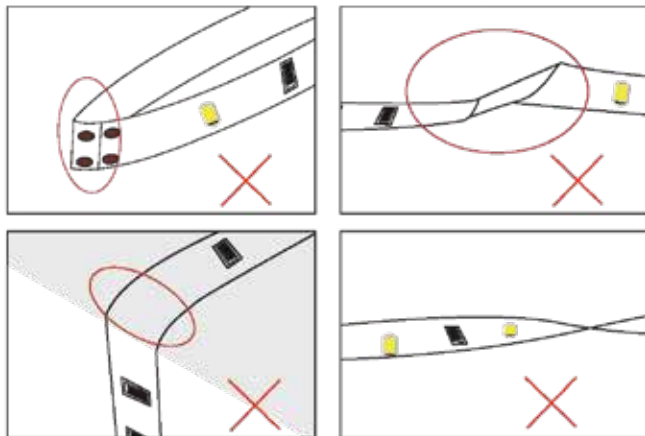

Distortion (Wrong)

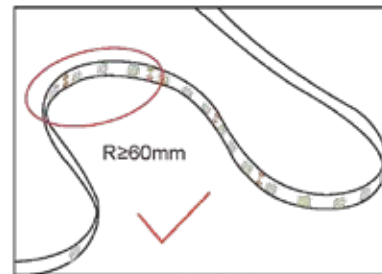

Bend (Right)

Tape is a low voltage product. DO NOT connect to 120V directly. This will permanently damage the tape and is not covered by warranty.