

DESIGN YOUR OWN BACKLIGHT LED MIRROR KIT

INSTALLATION EXAMPLE

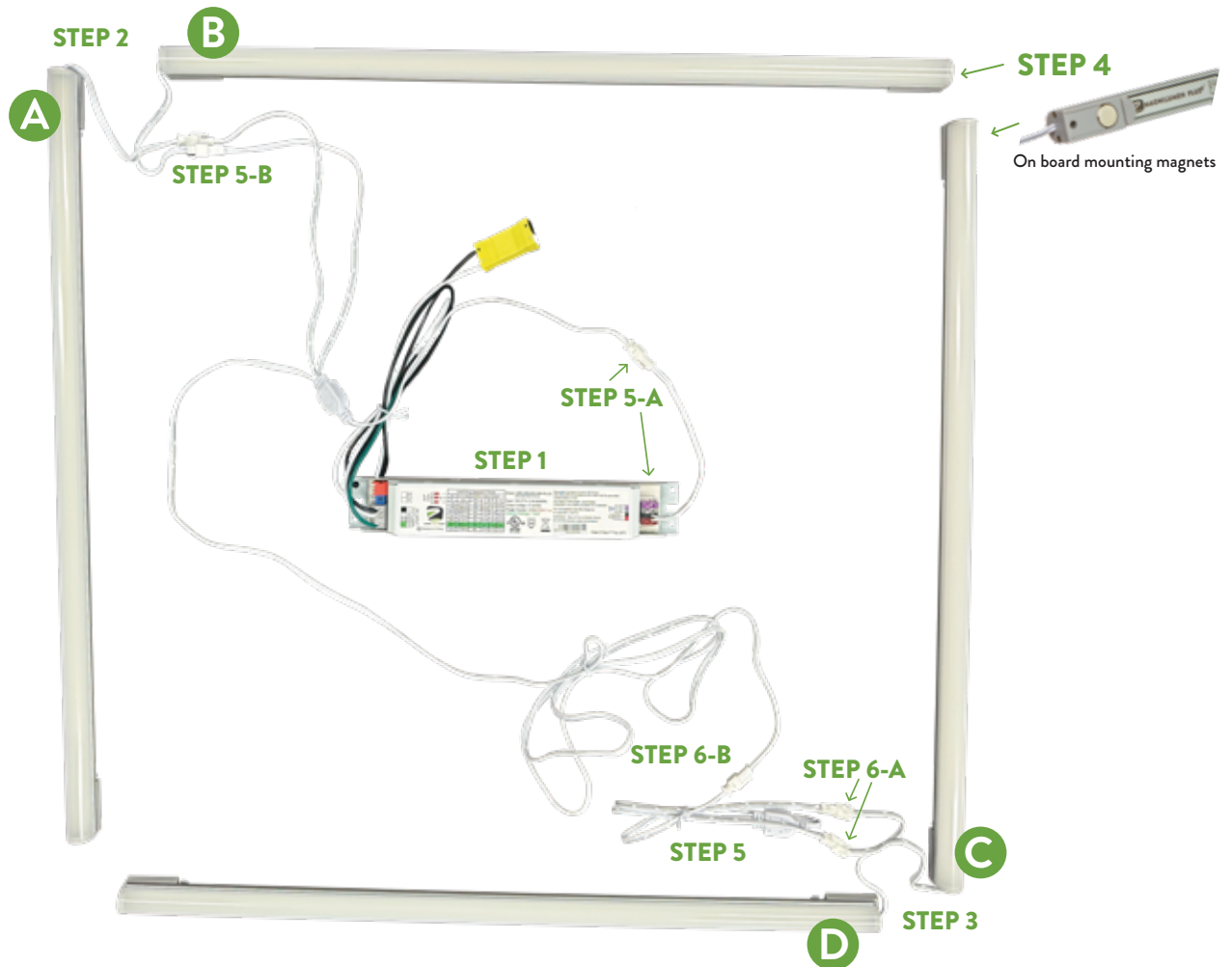

Installation Instructions

STEP 1: Disconnect Power before starting. Install the LED driver.

STEP 2: Position light bars **A** and **B** in their installation locations. These should form one vertical and one horizontal side, with their connection cords meeting at the top corner.

STEP 3: Position light bars **C** and **D** in their installation locations. These should also form one vertical and one horizontal side, with their connection cords meeting at the opposite corner from bars **A** and **B**. (On-board mounting magnets included.)

STEP 4: Attach the light bars to the mirror frame using the selected mounting method.

STEP 5:

A. Connect the single end of the 3-way harness to the driver wire connection.

B. Connect bars **A** and **B** to the short leads of the 3-way harness.

STEP 6:

A. Connect bars **C** and **D** to the 2-way harness dual end leads.

B. Connect the single end of the 2-way harness to the 6-foot lead of the 3-way harness.

FINAL STEP: Make final connection and turn on power.